

Do not scale from this drawing for construction or acquisition purposes. Responsibility is not accepted for errors made by others in scaling from this drawing. All construction information must be taken from figured dimensions only. All dimensions and levels must be checked on site and any discrepancies between drawings and specification must be reported to GSSArchitecture. © Copyright GSSArchitecture

Ordnance Survey © Crown Copyright 2018. All rights reserved. Licence number GSS 100017356.

Map Data Copyright 2018 Google.



**1. Proposed Site Section 01**  
SCALE - 1 : 500@A3

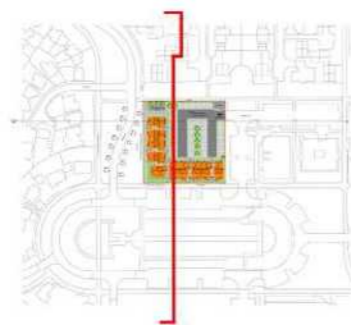

**2. Proposed Site Section 02**  
SCALE - 1 : 500@A3



A	23/07/19	EFR	CC	Updated to Planning Drawing
---	----------	-----	----	-----------------------------

Rev.	Date	Drawn	Checked	Description
------	------	-------	---------	-------------

**GSSarchitecture**

EXCHANGE HOUSE, 494 MIDSUMMER BOULEVARD,  
MILTON KEYNES, MK9 2EA  
Telephone: 01908 255 620. Email: gss@gotch.co.uk,  
Web: www.gssarchitecture.com

Gloucester: 01452 525 019, Kettering: 01536 513 165,  
Harrogate: 01423 815 121, Newcastle: 01913 898 917

This drawing is purely for discussion purposes only. It is not to be taken as a proposal for construction detailing, and instead it is primarily intended to convey the overall spatial layout of the building or parts of it. Please refer to the developed production information drawings for detail, construction and measurement purposes.

**PRELIMINARY ISSUE**

**Project Title:**  
Residential Development - Highgate Over, Walnut Tree

**Client:**  
Catalyst Land Solutions

**Drawing Title:**  
Proposed Site Sections

**File Number:** Project No. C211  
**Drawn By:** EFR  
**Checked By:** CC  
**Scale@A3:** 1 : 500 **Date:** 25/07/2019  
**Dwg No:** (SK)06 **Rev:** A